

# Invia<sup>®</sup> Abdominal Dressing Kit

## THERAPY CONFIDENCE WITH EASE

### Therapy Confidence

- **Protection** of abdominal content
- **Intelligent** Pressure Control from the pump to the wound site<sup>1</sup>
- **Dynamic** Exudate Removal helps prevent blockages from the wound site to the pump

### Simplified Management

- **Easy** to use<sup>2</sup>
- **Proprietary design**<sup>3</sup> of the pre-cut foam simplifies size adjustment
- **Intuitive** transparent film handling



The Invia Abdominal Dressing Kit from Medela provides an effective solution<sup>1</sup> for the management of open abdominal wounds with exposed viscera and organs including abdominal compartment syndrome.

The kit was designed for ease-of-use: 87% of the 15 surgeons involved in the usability testing found the product very easy to use. A **fenestrated Organ Contact Layer** protects the organs and enables an efficient fluid drainage from the abdomen.

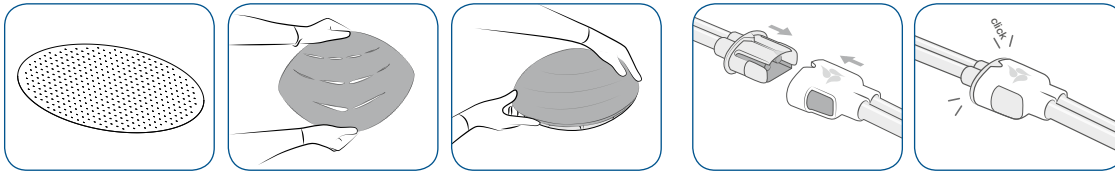

The **proprietary design of the pre-cut foam**<sup>3</sup> enables for a one side tear off, making it easier to adjust to the wound size.

The **Quick-connector** interface between the dressing tubing and pump tubing provides an easy and secure attachment<sup>2</sup>.

### Key features at a glance

- Intelligent Pressure Control from the pump to the wound site
- Dynamic Exudate Removal actively helps prevent blockages with air flow cycles adapting up to four times a minute
- Easy application of the organ contact layer
- Easy foam size adjustment due to one side tear off design
- Convenient and secure tubing attachment with the Quick-connector



### Technical data

<b>Organ Contact Layer</b> Polyurethane	Fenestrations: 5 mm	<b>Foam</b> Reticulated polyether and polyurethane, hydrophobic material	Pore size: 600–800 microns
	Thickness: 2.24 mil/63 µm Size: Oval (60 x 80 cm)		Tensile strength: 20 PSI/138 kPa Size: Oval (38 x 25 x 2 cm) PSI: Pounds per Square Inch
<b>Transparent Film</b> Polyurethane film with acrylic adhesive	MVTR: 385 g/m <sup>2</sup> /day		
	Size: 26 x 32 cm MVTR: Moisture Vapor Transmission Rate		

The Invia Abdominal Dressing Kit is intended to be used in conjunction with the Invia<sup>®</sup> Liberty™ Negative Pressure Wound Therapy (NPWT) System to deliver negative pressure to the wound.

Find out more about Medela NPWT Portfolio at [www.medelahealthcare.com](http://www.medelahealthcare.com)

Medical Vacuum Technology  
for Healthcare Professionals

**Please contact us or your local Medela representative for details.**

Medela, Invia and Invia FitPad are trademarks of Medela Holding AG, Switzerland.

#### Local contact



Medela AG  
Lättichstrasse 4b  
6341 Baar, Switzerland  
[www.medelahealthcare.com](http://www.medelahealthcare.com)

**United Kingdom**  
Medela UK Ltd.  
Huntsman Drive  
Northbank Industrial Park  
Irlam, Manchester M44 5EG  
United Kingdom  
Phone +44 161 776 0400  
Fax +44 161 776 0444  
[info@medela.co.uk](mailto:info@medela.co.uk)  
[www.medelahealthcare.co.uk](http://www.medelahealthcare.co.uk)

**International Sales**  
Medela AG  
Lättichstrasse 4b  
6341 Baar  
Switzerland  
Phone +41 41 562 51 51  
Fax +41 41 562 51 00  
[customercare@medela.ch](mailto:customercare@medela.ch)  
[www.medelahealthcare.com](http://www.medelahealthcare.com)



<sup>1</sup> Performance data on file at Medela AG  
<sup>2</sup> Usability Validation data on file at Medela AG  
<sup>3</sup> Patent pending